

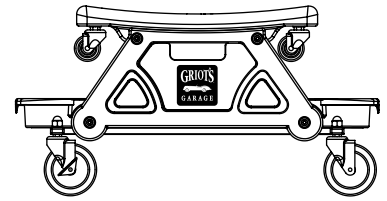

# Compact Sit-On Creeper II

ITEM# 38953 | INSTRUCTIONS



## ITEM, HARDWARE & PARTS INCLUDED

#		UNIT	QTY	#	ITEM	UNIT	QTY
A	Main Body Assembly w/ Mini-Creeper Installed	SET	1	4	M6 Washer	PCS	8
1	Tool Tray	PCS	2	5	M6 Nyloc Nuts	PCS	4
2	Bottom Frame and Wheel Assembly	SET	2	6	Center Drawer	PCS	1
3	M6 x 45mm Screw	PCS	4				

Fig 1: Creeper components

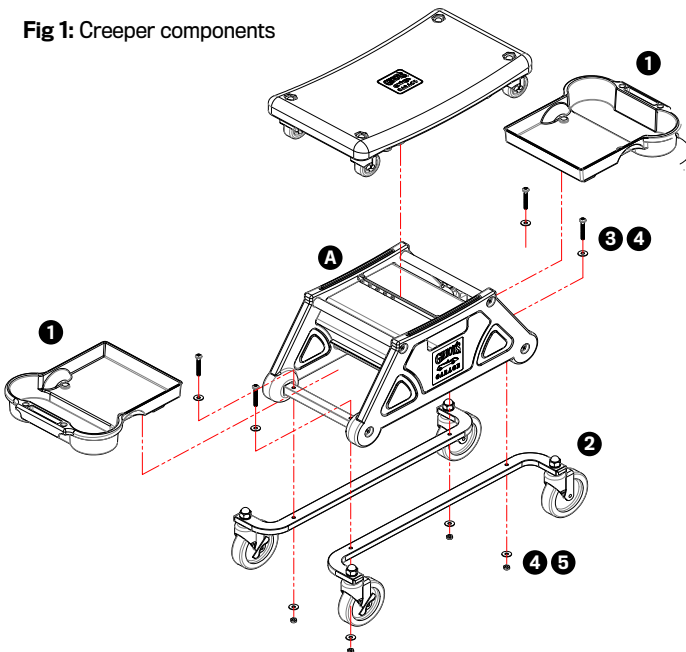

**IMPORTANT:** READ ALL INSTALLATION STEPS BEFORE BEGINNING ASSEMBLY

**Tools Required:** 4mm Hex Driver or Allen Wrench and 10 mm socket with driver/ratchet

### Installation Steps:

1. Organize all components on a clean space on a workbench or the floor. The Mini Creeper is factory pre-installed on the creeper frame. The full Mini Creeper can be removed by placing a foot on a wheel and pulling the seat top upwards. Removing the Mini Creeper is not necessary for assembly .
2. Place the Compact Sit-On Creeper II main body assembly (A) upside down on your work surface.
3. Take one of the Bottom Frame and Wheel Assemblies (2) placing it on the main body assembly with the casters aligned outwards and the fastener holes lined up.
4. Insert two M6 x 45 mm screws (3) with washers through the mounting holes from the top side of the main body assembly frame (See Fig: 1). Place two M6 nyloc nuts (5) with washers (4) onto the screws protruding through the bottom of the Bottom Frame and Wheel Assembly (2). Holding the screws with a 4 mm hex driver, tighten the M6 nyloc nuts (5) with a 10 mm socket and driver/ratchet until they are snug to the bottom frame. Do not overtighten.
5. Repeat steps 3-4 with the second Bottom Frame and Wheel Assembly (2) piece on the other side.
6. Turn the creeper assembly over onto its wheels. Double check that all fasteners are tightened securely.
7. Take Tool Tray (1) and insert on one side of the cart bottom frame at a 45-degree angle. Push downward firmly on the end of the Tool Tray near the bottle holders until the clips lock into place on the frame. If locking the trays in place is difficult you can reach underneath the tray and push the clips inward toward the center of the creeper to allow the trays to lock in place easily (See Fig: 3). Repeat with 2nd Tool Tray on opposite side of creeper.
8. Sit on the cart and test that all casters and frame pieces are fully secure. If not, re-tighten any loose fasteners. Now go have fun in your garage!

Fig 2: Showing Mini Creeper removed from main creeper frame

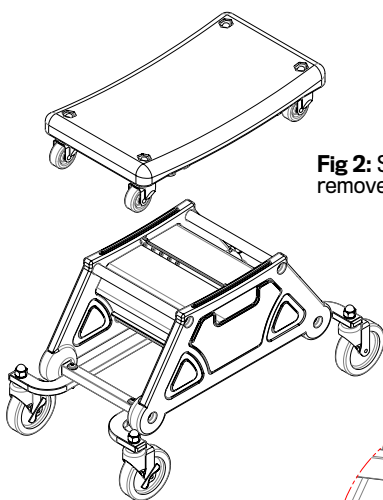
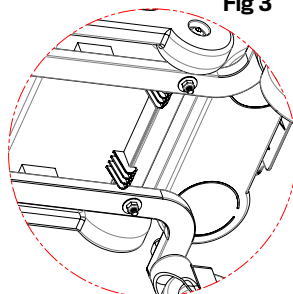

Fig 3



**Note:** Over time with regular use, there is a chance that fasteners may become loose. Check fasteners periodically to ensure everything is secure and safe for use. The creeper body and trays can be safely cleaned with multiple products including Interior Cleaner, Interior Detailer, Speed Shine®, etc.

**CAUTION:** DO NOT stand on the full creeper or Mini Creeper for any reason!

*Have fun in your garage!®*